

High Pressure Pipeline Equipment



SENOIL

Outstanding Product and Service

Senoil pup joint is designed to be compatible with FMC Chicksan pup joints based on technology imported from FMC pup joints.

To ensure the quality, our pup joints are forged by the high quality alloy steel. All processes including forging, machining, heat treatment and pressure test are strictly controlled and fully traceable in according with API 6A, API 16c and Q1, as well as NACE-MR-01-75 (sour gas service), full packages of Material Test Report can be sent with consignment upon client's request.

Integral Pup Joints are available in sizes ranging from 1" to 4" and can handle up to 15,000 psi for either standard service or sour gas service.

Pup Joint

-Treating Iron

Recommended Service

- High Pressure well service flowline
- Fracturing flowline
- well testing flowline
- Cementing and circulating flowline
- early production facility



Features

- Integral pup joint is made from one forged raw pipe
- Flanged end is available for high pressure pipeline
- ACME thread is adopted in Weco wing union
- Thread connection can be adopted for low pressure pup joint
- Full Traceability

SENOIL

Available

- Colding work pressure: 2000psi to 15000psi
- Nominal bore size: 1", 1.5", 2", 3", 4", 6"
- End connection: thread, weco wing union, flange
- Sour Gas service is available

Specification

Description	Weco Connection	Service	Cold W.P (psi)	1.5"	2"	3"	4"
Integral Pup Joint Welded Pup Joint	Fig 206	Standard	2,000	Y	Y	Y	Y
		H ₂ S	2,000				
	Fig 602	Standard	6,000	Y	Y	Y	Y
		H ₂ S	6,000				
	Fig 1002	Standard	10,000	Y	Y	Y	
		H ₂ S	7,500				
	Fig 1502	Standard	15,000	Y	Y	Y	
		H ₂ S	10,000				
	Fig 2202	Standard	20,000	Y	Y	Y	
		H ₂ S	15,000				



For more information, please contact our sales (contact@shsenoil.com)

Senoil offers a full line of Swivel joints which is a metal pipe adapter installed with roller bearings based based on introduced technology imported from FMC swivel joints.

Swivel joints are divided into short and long radius swivel joints. Long radius swivel joints can minimize fluid resistance and have better performance in corrosion resistance than short radius ones due to their smooth bore. But short radius swivel joints are needed where the working space is limited.

Our high quality swivel joints are specially heat-treated and inspected in order to control hardness to qualified according to NACE MR 0175.

Swivel Joint

Recommended Service

- High Pressure well service flowline
- Fracturing flowline
- well testing flowline
- Cementing and circulating flowline
- early production facility











Features

- Working pressure: from 2,000psi to 15,000psi
- Leak detection port
- Interchangeable to FMC Chiksan swivel joint
- style 10, 20, 30, 50, 60, 70, 80, 100 are available

SENOIL

Swivel Joint

Available Size

Style	W.P (psi)	Service	Weco Connection	Available Size
20 	6,000	Standard	Fig 602	1", 1.5", 2", 3", 4"
		H ₂ S	Fig 602	
	10,000	Standard	Fig 1002	1", 1.5", 2", 3"
		H ₂ S	Fig 1502	
		Standard	Fig 1502	
	30 	6,000	Standard	Fig 602
H ₂ S			Fig 602	
10,000		Standard	Fig 1002	1", 1.5", 2", 3"
		H ₂ S	Fig 1502	
		Standard	Fig 1502	
40 		6,000	Standard	Fig 602
	H ₂ S		Fig 602	
	10,000	Standard	Fig 1002	1", 1.5", 2", 3"
		H ₂ S	Fig 1502	
		Standard	Fig 1502	
	50 	6,000	Standard	Fig 602
H ₂ S			Fig 602	
10,000		Standard	Fig 1002	1", 1.5", 2", 3"
		H ₂ S	Fig 1502	
		Standard	Fig 1502	
60 		6,000	Standard	Fig 602
	H ₂ S		Fig 602	
	10,000	Standard	Fig 1002	1", 1.5", 2", 3"
		H ₂ S	Fig 1502	
		Standard	Fig 1502	
	70 	6,000	Standard	Fig 602
H ₂ S			Fig 602	
10,000		Standard	Fig 1002	1", 1.5", 2", 3"
		H ₂ S	Fig 1502	
		Standard	Fig 1502	
80 		6,000	Standard	Fig 602
	H ₂ S		Fig 602	
	10,000	Standard	Fig 1002	1", 1.5", 2", 3"
		H ₂ S	Fig 1502	
		Standard	Fig 1502	
	10 	6,000	Standard	Fig 602
H ₂ S			Fig 602	
10,000		Standard	Fig 1002	1", 1.5", 2", 3"
		H ₂ S	Fig 1502	
		Standard	Fig 1502	
100 		6,000	Standard	Fig 602
	H ₂ S		Fig 602	
	10,000	Standard	Fig 1002	1", 1.5", 2", 3"
		H ₂ S	Fig 1502	
		Standard	Fig 1502	

For more information, please contact our sales (contact@shsenoil.com)

Senoil plug valve is designed to be compatible with FMC ULT plug valve based on technology imported from FMC.

To ensure the quality, our plug valve body are forged by the high quality alloy steel. All processes including forging, machining, heat treatment and pressure test are strictly controlled and fully traceable in according with API 6A, API 16C and Q1, as well as NACE-MR-01-75 (sour gas service), full packages of Material Test Report can be sent with consignment upon client's request.

Plug valve is available in sizes ranging from 1" to 3" and can handle up to 15,000 psi for either standard service or sour gas service.

Besides ULT type, we also can supply SPM EXL type, and Halliburton type plug valve.

Plug Valve

Recommended Service

- High Pressure well service flowline
- Fracturing flowline
- well testing flowline
- Cementing and circulating flowline

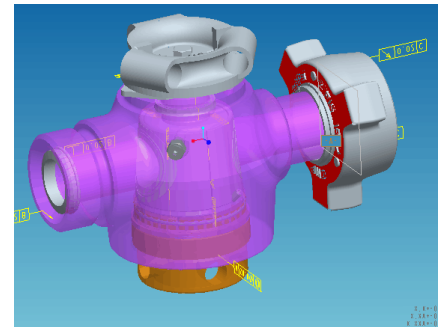
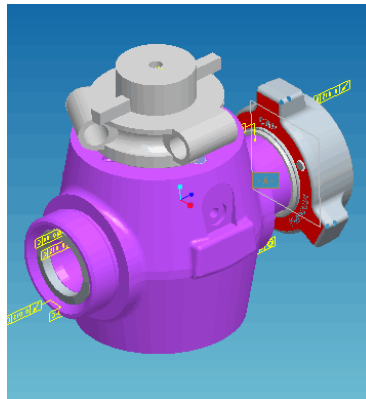

Features

- Forged body by alloy steel
- Low torque operation
- Flanged connection is available
- Fast, simple field repair

SENOIL

Available

- Colding work pressure: 2000psi to 15000psi
- Nominal bore size: 1", 1.5", 2", 3"
- End connection: thread, weco wing union, flange
- Sour Gas service is available

Specification

Description	Weco Connection	Service	Cold W.P (psi)	1"	1 x2"	2"	3"
Plug Valve	Fig 1002	Standard	10,000	Y	Y	Y	Y
		H ₂ S	7,500	Y	Y	Y	Y
	Fig 1502	Standard	15,000	Y	Y	Y	Y
		H ₂ S	10,000				
	Fig 2202	Standard	20,000	/	/	/	Y
		H ₂ S	15,000				



For more information, please contact our sales (contact@shsenoil.com)

Senoil check valve is designed to be compatible with FMC top entry, in-line flapper and dart type check valve based on technology imported from FMC.

To ensure the quality, our check valve body and cover are forged by the high quality alloy steel. All processes including forging, machining, heat treatment, and pressure test are strictly controlled and fully traceable in according with API 16C and Q1, as well as NACE-MR-01-75 (sour gas service), full packages of MTR can be sent with consignment upon client's request.

Check valve is available in sizes ranging from 1" to 3" and can handle up to 15,000 psi for either standard service.

Besides FMC type, we also can supply Lift Check valve which is designed according to API 6A.

Check Valve

Recommended Service

- High Pressure well service flowline
- Fracturing flowline
- well testing flowline
- Cementing and circulating flowline

Features

- Forged body by alloy steel
- Easy maintenance
- Weco connection to make sure durability
- Fast, simple field repair
- Single flow direction

Top Entry check valve



Nominal Size	CWP	Service	End connection
2"	15,000	Standard	Fig 1502
	10,000	Sour Gas	Fig 1502
3"	15,000	Standard	Fig 1502
	10,000	Sour Gas	Fig 1502
	6,000	Standard	Fig 602
4"	10,000	Standard	Fig 1002
	6,000	Standard	Fig 602

In-line flapper check valve

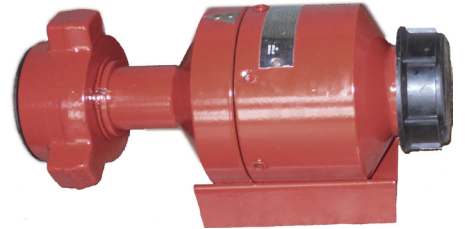

Nominal Size	CWP	Service	End connection
1"	15,000	Standard	Fig 1502
1-1/2"	15,000	Standard	Fig 1502
2"	20,000	Standard	Fig 2002
3"	20,000	Standard	Fig 2002

Dart Type check valve



Nominal Size	CWP	Service	End connection
1"	15,000	Standard	Fig 1502
1-1/2"	15,000	Standard	Fig 1502
2"	15,000	Standard	Fig 2002
3"	15,000	Standard	Fig 2002

For more information, please contact our sales (contact@shsenoil.com)

Senoil wing union is designed to be compatible with FMC Weco Wing Union based on technology imported from FMC.

To ensure the quality, our union sub and wing nut forged by the high quality alloy steel. All processes including forging, machining, and heat treatment are strictly controlled and fully traceable in according with API 16C and Q1, as well as NACE-MR-01-75 (sour gas service), full packages of Material Test Report can be sent with consignment upon client's request.

Wing union is available in sizes ranging from 1" to 4" and can handle up to 15,000 psi for either standard service.

Wing Union

Recommended Service

- High Pressure well service flowline
- Fracturing flowline
- well testing flowline
- Cementing and circulating flowline





Features

- Forged Alloy Steel is adopted
- Replaceable
- Thread or Butt-welded end is available
- Metal to metal seal for high pressure union

SENOIL

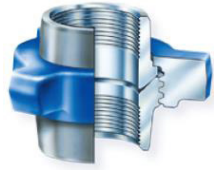
Specification

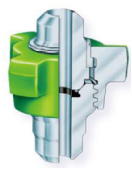
Fig NO.	Fig Photo	Pressure Rating (psi)				Available Size
		Standard		Sour Gas		
		Cold Working	Test	Cold Working	Test	
200		2,000	3,000	N/A	N/A	1",2",3",4"
206		2,000	3,000	N/A	N/A	1",2",3",4",6"
602		6,000	9,000	6,000	9,000	1",2",3",4"
1002		10,000	15,000	10,000	15,000	1",2",3",4"
1003		10,000	15,000	10,000	15,000	2",3",4"
1502		15,000	22,500	N/A	N/A	1",2",3",4"
2002		20,000	30,000	20,000	30,000	2",3"
2202		N/A	N/A	15,000	22,500	2",3"

For more information, please contact our sales (contact@shsenoil.com)

Senoil hose loop is designed to be compatible with FMC Circulating hose based on technology imported from FMC.

To ensure the quality, our pup joint and swivel joint main body are forged by the high quality alloy steel. All processes including forging, machining, and heat treatment are strictly controlled and fully traceable in according with API 16C and Q1, as well as NACE-MR-01-75 (sour gas service), full packages of Material Test Report can be sent with consignment upon client's request.

Our hose loop can handle a complete range of sour gas and standard fluids at cold working pressure up to 15,000 psi. These all-steel hoses are available from 1" to 3". All materials meet ASTM standards.

Hose Loop

-Circulating Hose

Recommended Service

- High Pressure well service flowline
- Fracturing flowline
- well testing flowline
- Cementing and circulating flowline



Features

- Wing union connections ensure fast, pressure-tight connections
- Fold up easily and quickly for transportation
- Hose loop extended length can be chosen

SENOIL

Available

- Colding work pressure: 2000psi to 15000psi
- Nominal bore size: 1", 1.5", 2", 3"
- End connection: weco wing union
- Sour Gas service is available

Specification

Nominal Size	Service	CWP. (psi)	Fig. NO.	Swivel Joint style #1/#2	Length in extended condition (ft)		
					10	12	9.5
1"	Standard	6,000	602	50/50	Y	Y	-
1.5"	Standard	6,000	602	50/50	Y	Y	-
1.5"	Standard	10,000	1502	50/50	Y	Y	-
	Standard	15,000	1502	50/10	-	-	Y
2"	Standard	6,000	602	50/50	Y	Y	-
2"	Standard	10,000	1502	50/50	Y	Y	-
	Standard	15,000	1502	50/10	-	-	Y
2"	Sour Gas	10,000	1502	50/10	-	-	Y
3"	Standard	6,000	602	50/50	Y	Y	

For more information, please contact our sales (contact@shsenoil.com)

Senoil offers full line integral fittings which are designed to be compatible with FMC integral fittings based on technology imported from FMC.

To ensure the quality, our integral fittings are forged by the high quality alloy steel. All processes including forging, machining, heat treatment and pressure test are strictly controlled and fully traceable in according with API 16C and Q1, as well as NACE-MR-01-75 (sour gas service) if need. Full packages of Material Test Report can be sent with consignment upon client's request.

Our integral fittings can handle a complete range of sour gas and standard fluids at cold working pressure up to 15,000 psi. These fittings are available from 1" to 3". All materials meet ASTM standards.

Integral Fittings

Recommended Service

- High Pressure well service flowline
- Fracturing flowline
- Well testing flowline
- Cementing and circulating flowline

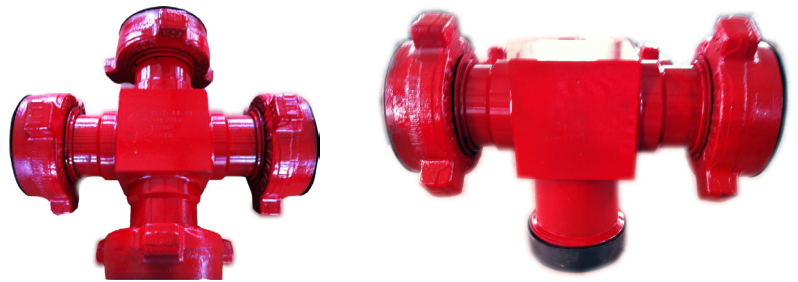





Features

- Wing union connections ensure fast, pressure-tight connections
- Many end connection combination can be chosen
- All are forged ones

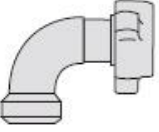
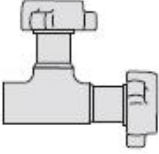
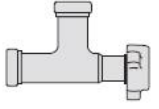
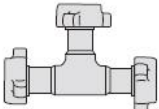
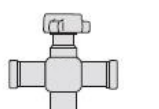
SENOIL

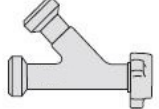
Specification

Style	W.P (psi)	Service	O. NO.	Available Size
	6,000	Standard	602	2", 3", 4"
		H ₂ S	602	
	10,000	Standard	1002	2", 3", 4"
		H ₂ S	1502	2", 3"
	15,000	Standard	1502	2", 3"
		6,000	Standard	602
H ₂ S			602	
10,000		Standard	1002	1", 1.5", 2", 3"
		H ₂ S	1502	
15,000		Standard	1502	
		6,000	Standard	602
	H ₂ S		602	
	10,000	Standard	1002	1", 1.5", 2", 3"
		H ₂ S	1502	
	15,000	Standard	1502	
		6,000	Standard	602
H ₂ S			602	
10,000		Standard	1002	1", 1.5", 2", 3", 4"
		H ₂ S	1502	
15,000		Standard	1502	
		6,000	Standard	602
	H ₂ S		602	
	10,000	Standard	1002	1", 1.5", 2", 3"
		H ₂ S	1502	
	15,000	Standard	1502	
		6,000	Standard	602
H ₂ S			602	
10,000		Standard	1002	1", 1.5", 2", 3"
		H ₂ S	1502	
15,000		Standard	1502	
		6,000	Standard	602
	H ₂ S		602	
	10,000	Standard	1002	1", 1.5", 2", 3"
		H ₂ S	1502	
	15,000	Standard	1502	
		6,000	Standard	602
H ₂ S			602	
10,000		Standard	1002	1", 1.5", 2"
		H ₂ S	1502	
15000		Standard	1502	

For more information, please contact our sales (contact@shsenoil.com)

For further information and service, please contact as below:
Email: contact@shsenoil.com
website: www.shsenoil.com